

Pin No.	Symbol
A1	CLK or BPDx
A2	SCL
A3	WP
A4	VCCH
B1	DO7
B2	VSS
B3	SDA
B4	DO0
C1	DO6
C2	TIMEN or RESX
C3	DO3
C4	DO1
D1	DO5
D2	DO4
D3	VCCL
D4	DO2

No. HA016-C-P-SD-2.0

TITLE	WLP-16A-C-PKG Dimensions (S-7760A)
No.	HA016-C-P-SD-2.0
ANGLE	
UNIT	mm
ABLIC Inc.	

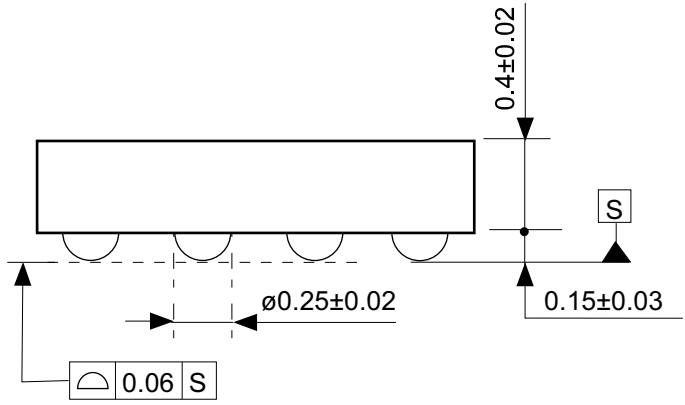
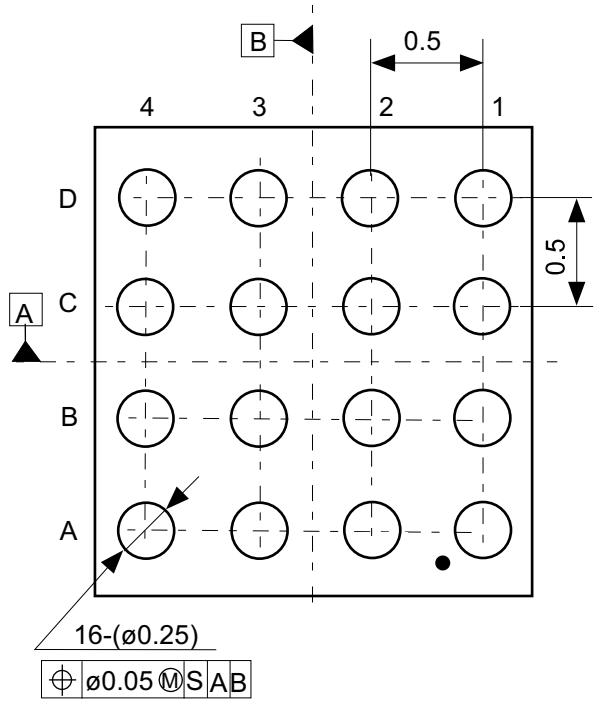
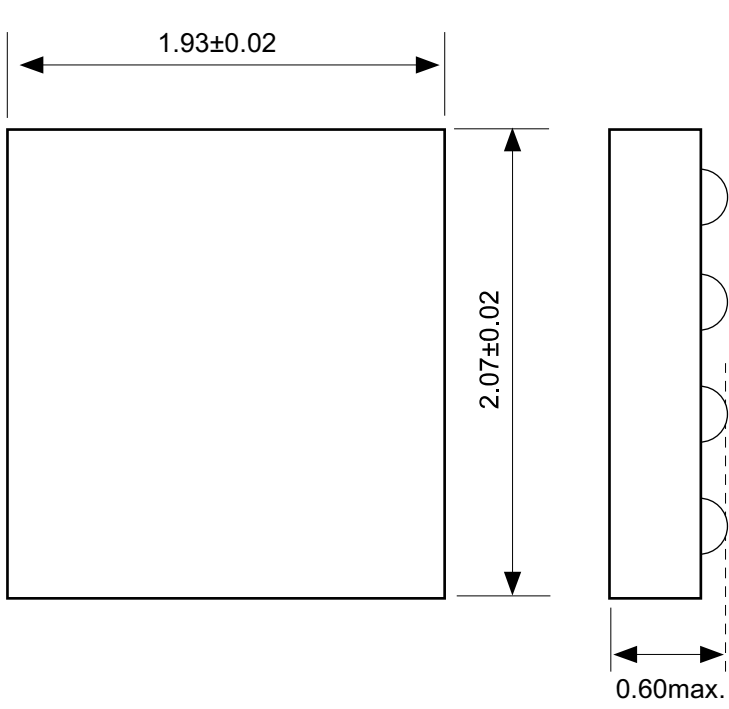

Pin No.	Symbol
A1	TEST
A2	SCL
A3	WP
A4	VCCH
B1	DO7
B2	VSS
B3	SDA
B4	DO0
C1	DO6
C2	TIMEN
C3	DO3
C4	DO1
D1	DO5
D2	DO4
D3	VCCL
D4	DO2

No. HA016-C-P-S1-1.0

TITLE	WLP-16A-C-PKG Dimensions (S-7760A4115)
No.	HA016-C-P-S1-1.0
ANGLE	
UNIT	mm
ABLIC Inc.	

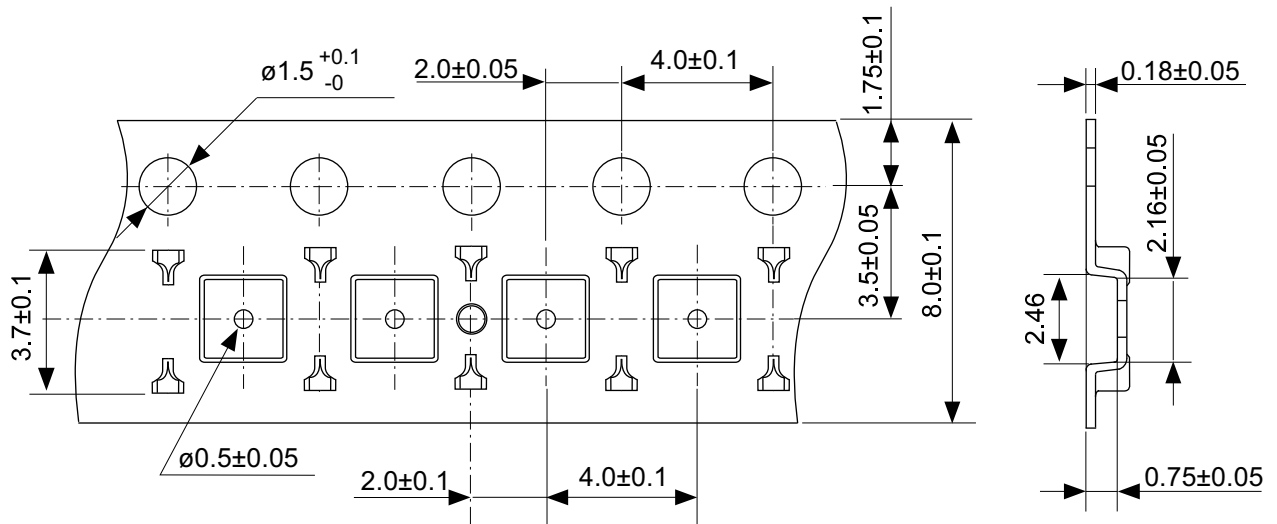

Count mark (ø0.8, Depth 0.2)
(Every 10 pockets)

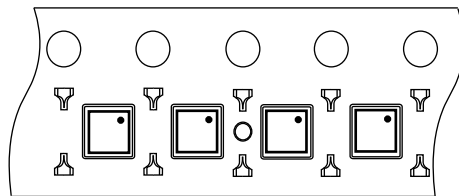
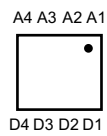
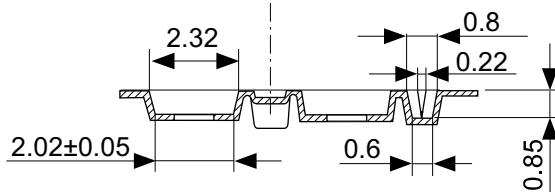

Feed direction

No. HA016-C-C-SD-1.1

TITLE	WLP-16A-C-Carrier Tape (S-7760A)
No.	HA016-C-C-SD-1.1
ANGLE	
UNIT	mm
ABLIC Inc.	

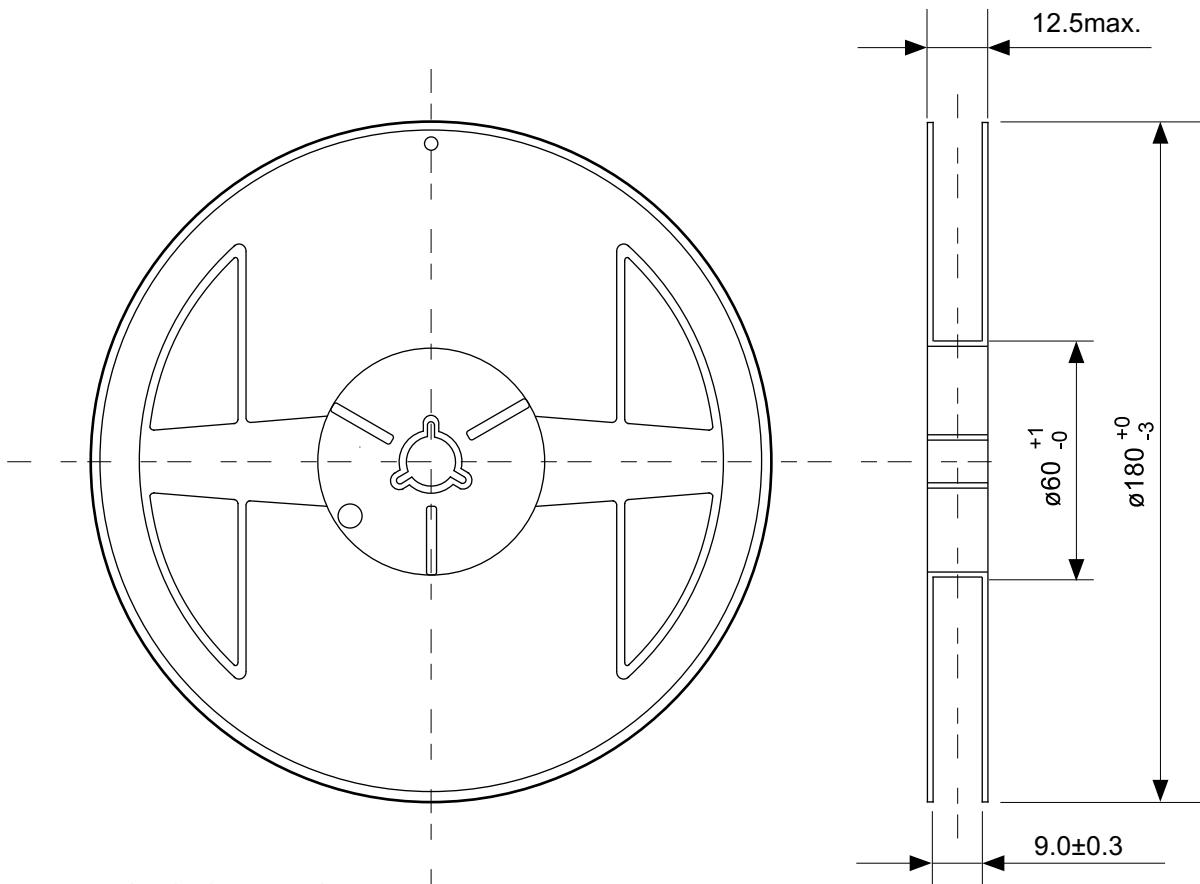

Enlarged drawing in the central part

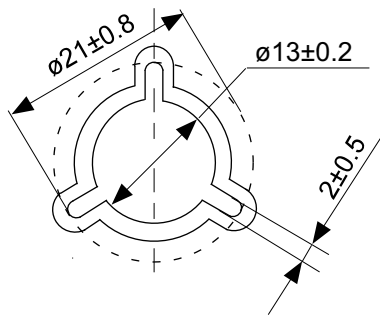

No. HA016-C-R-SD-1.0

TITLE	WLP-16A-C-Reel (S-7760A)		
No.	HA016-C-R-SD-1.0		
ANGLE		QTY.	3,000
UNIT	mm		
ABLIC Inc.			

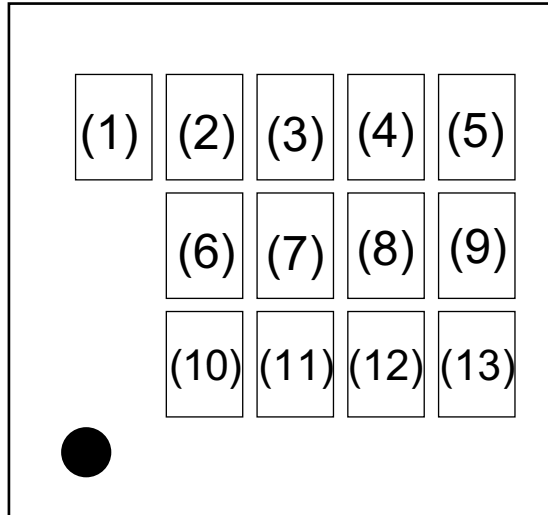

(1) to (9) : Product code

(10) to (13) : Lot code

● : A1 Pin mark

No. HA016-C-M-SD-3.0

TITLE	WLP-16A-C-Markings (S-7760A)		
No.	HA016-C-M-SD-3.0		
ANGLE			
UNIT		TYPE	LASER
ABLIC Inc.			

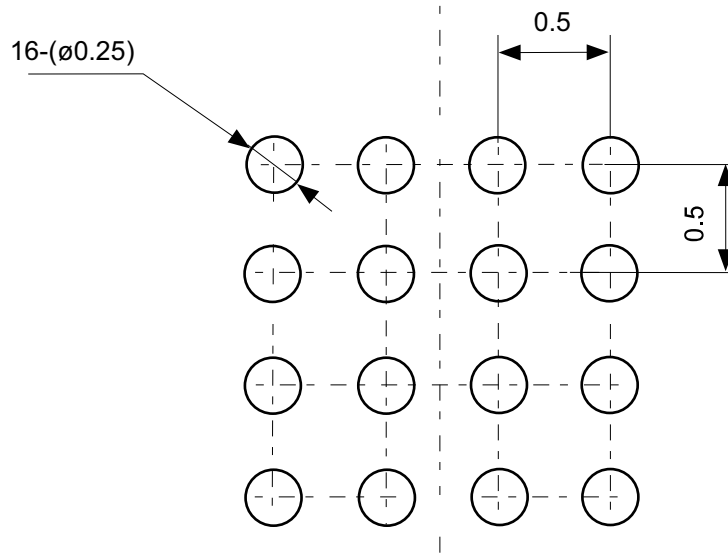

No. HA016-C-L-SD-1.0

TITLE	WLP-16A-C-Land Recommendation (S-7760A)
No.	HA016-C-L-SD-1.0
ANGLE	
UNIT	mm
ABLIC Inc.	